



the SAN JUAN
PRESERVATION
TRUST

Box 327
Lopez Island, WA 98261
360.468.3202 (Lopez office)
360.378.2461 (Friday Harbor office)
www.sjpt.org

IN THIS ISSUE:

- Campaign to Save "The Mountain" on Guemes Island
- Bluebird Reintroduction Project Caps
- Conservation Easement Tax Incentives Extended
- Staff Changes at the Preservation Trust
- Memorials and Other Gifts

ADDRESS SERVICE REQUESTED

NON-PROFIT ORG.
US POSTAGE
PAID
LOPEZ ISLAND, WA
PERMIT NO. 3



the SAN JUAN
PRESERVATION
TRUST

SUMMER 2008

WWW.SJPT.ORG



GET YOUR BLUEBIRD CAP

There's a new hat in town, and it can be yours when you support our efforts to reintroduce the Western bluebird to the San Juan Islands! By purchasing one of these quality hats with a Western bluebird on the front and "San Juan Islands Bluebird Reintroduction" on the back, you can help fund the project for 2009.

The hats are "free" with a donation of \$150 or more. All proceeds go directly to the San Juan Islands Western Bluebird Reintroduction Project fund. We have had an amazingly successful 2008 so far, but additional funds are needed to keep the project going in 2009.

To get your cap today, please write "Bluebird" on your check and mail it using the enclosed envelope.

Land & Legacy

CAMPAIGN TO SAVE HIGHEST POINT ON GUEMES ISLAND

Raising Funds in Small Community Poses Huge Challenge

THE SAN JUAN PRESERVATION TRUST has an immediate opportunity to conserve the summit of another mountain, this time on Guemes Island, a small island on the eastern edge of the San Juan archipelago. A quiet, pastoral place accessible only by a small county-operated ferry that originates in downtown Anacortes, Guemes is perhaps most loved for its resourceful, passionate and colorful residents.

Locals simply refer to this undeveloped 70-acre property as "The Mountain." Generations of island families and visitors have hiked to the summit to enjoy spectacular wildflower blooms and panoramic views of Mt. Baker, the ports of Anacortes and Bellingham, the Cascade and Olympic mountain ranges, and the surrounding islands and waterways.

The San Juan Preservation Trust and Skagit Land Trust have partnered with the Guemes community to raise the \$2.8 million needed to acquire the property. While a generous island family has already committed \$1 million to the campaign, and a handful of other people have pledged just over \$230,000 as we go to press, the conservation partnership still has to raise nearly \$1.6 million to conserve this land and make it publicly accessible in perpetuity.

While this opportunity is great, so is our challenge: Raising funds on a remote island with fewer than 700 residents has proven to be a formidable task.

FEASIBILITY CAMPAIGN We have initiated a feasibility campaign to determine if we can raise the funds needed to acquire the property. During this feasibility effort, we are only seeking pledges of \$10,000 or more (we are not seeking smaller gifts at this time). If we can secure pledges for 80% of the \$2.8 million project goal by November 2008 (2 months from now), then the partnership will commit non-refundable earnest money to extend the sales agreement by 9 months (to September 2009). If we fail to secure pledges for 80% of the goal by this fall, then the partnership will have no choice but to terminate the agreement, enabling the property owners, Panoramic View Enterprises LLC, to continue their effort to sell "The Mountain" to private landowners or developers.

We rely upon you, our members, to answer the call when an important piece of our islands is under threat. Please look inside to learn more about "The Mountain" campaign, and let us know if you (or someone you know) are able to make a leadership pledge. (More about "The Mountain" inside)



Mehari Doran Cline tosses candy to 4th of July parade-goers on Guemes Island where the San Juan Preservation Trust and Skagit Land Trust are working to conserve the highest point on Guemes. "The Mountain" is an important part of the local natural heritage. Read more inside about how citizens and conservation groups are partnering to save this island treasure.



the SAN JUAN
PRESERVATION
TRUST

Land & Legacy

SUMMER 2008

WWW.SJPT.ORG

TAX BENEFITS EXTENDED FOR CONSERVATION EASEMENT DONORS

PRIVATE LANDOWNERS play a critical role in preserving natural landscapes and agricultural land in the San Juan Islands. New legislation recently passed by Congress has renewed a powerful tax incentive for voluntary conservation agreements. This renewed incentive extends through 2009 and raises the deduction a donor can take for donating a voluntary conservation easement from 30% to 50% of adjusted gross income in any year (farmers and ranchers may deduct up to 100% of adjusted gross income) and increases the period a donor can continue to take deductions from 6 to 16 years. This new law will expand opportunities for island landowners to protect cherished places for their children and future generations.

For more information on these new developments please call Debby Clausen at 360.378.2461 or visit our website at www.sjpt.org



Sheri Miklaski



Sven Haarhoff



Diana Stepita

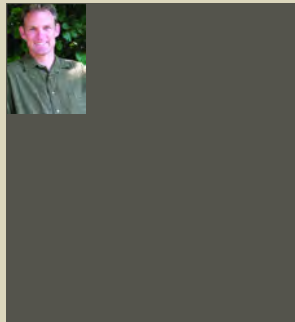

Brian Windrope

STAFF CHANGES AT THE PRESERVATION TRUST

TWO STAFF MEMBERS have left us to pursue new adventures. **Sheri Miklaski**, who served as office manager for five years, drove east to pursue a graduate degree in library sciences at The University of Texas at Austin. **Sven Haarhoff**, who served as our director of charitable giving the past four years, flew west after accepting the director of philanthropy position at The Nature Conservancy of Hawaii. Both Sheri and Sven worked closely with our members to help conserve island properties, including Turtleback Mountain on Orcas and Watmough Bight on Lopez. We thank them for being links in the chain of conservationists who help keep our islands beautiful. Their energy lives on in the lands they helped to conserve.

Meanwhile, several new links have joined the chain. **Diana Stepita** is our new membership program manager. Diana's background is in marketing and database management. Her work with the Westchester Land Trust in New York helped raise awareness and funds to protect the local watershed. She and her husband and son live on San Juan Island. **Brian Windrope** is our new director of philanthropy. Brian earned a master's in education from Stanford University and has worked in the field of education and nonprofit administration for over twenty years. His recent background includes tenure as executive director of Opal Creek Ancient Forest Center in Oregon; director of a residential astronomy school for Guided Discoveries in California; and director of education and outreach for Yosemite National Institutes. Brian and his family live on San Juan Island.

Kathy Holliday serves as our new executive assistant. Kathy, who recently moved to Lopez Island, previously worked in Seattle as a senior academic counselor for students at The University of Washington's School of Drama and Department of Comparative Literature. She also has worked at The University of Washington's Medical Center, The University of Minnesota and The Minneapolis College of Art and Design. She graduated magna cum laude from Augsburg College in Minneapolis with a bachelor's in English and history. (No photo available at press time.)

MEMORIALS AND OTHER GIFTS SPRING 2008

- MEMORIALS
Michael Haff
Patty and Jerry Rasmussen
Florence Machin
Susan and Gerry Christensen
Ruth Ellen Helsell Perkins
Jean Dowling
Marie Whitnall
Jerry and Patty Rasmussen
Grandmother Terry Eaton
Theresa Zaydel
David Chancellor Black
Betsy and Henry Judson
Bill Horder
Judy and Kermit Rosen
Peter and Erica Dodd
Barbara Noyes
Jack and Jan Helsell
Nancy and Richard Cleveland
Ferdie Businger
Dale and Suzanne Roundy
Emily Dexter
Marilyn and Bartow Fite
Eliot and Tina Scull
Stephen and Lisa Robertson
Walter and Constance Phelps
Mike and Diane Cooper
Speight Drummond
Patty and Jerry Rasmussen
John Crosby
Sarah Crosby
Bob Roseburg
Julie Hansen
Patricia Young and Kramer Adams
Jeanne Lee
Alice Johnson
Rich and Kate Lee
Judge Phillip Sweigert
Lowell and Shirley Knutson
Paul and Ann Hanson

- Edwin Thorpe
Sarah Crosby
Dorothy Richardson
Barbara Klee and Ralph Pease
- IN HONOR OF
Jim Phillips' 65th birthday!
Penny Morris
Sherrie Wilson's 60th birthday!
Melvin and Deborah Morgan
Traci Burgler
and Mike Behlke's birthdays!
Sheri and Jim Emerson
Birth of Oliver Lawrence Morgan
Miriam and Richard Morgan
The Johnson Wedding
Eric and Ludmila Mayhew
Jessica Wiseman and Travis Baldwin
- BUSINESS AND FOUNDATION GIFTS
Microsoft Giving Campaign
Black Dog Bicycles
Pacific Cascade Services
The Seattle Foundation
The Delta Company
The Diversity Foundation
Prudential Foundation Matching
Gifts Program
Global Impact/Yahoo! Matching Gifts
Bill & Melinda Gates Foundation
Matching Gifts
IBM Matching Gifts
Wachovia Foundation Matching
Gifts Program
Beach Haven Resort
Skagit Gardens
BOEING Matching Gift Program
Regence Employee Giving Campaign
Adobe Matching Gift Program



Dodie Gann and her late husband, Ernest, protected their 748-acre Red Mill Farm -- a working ranch on Lopez Island -- with a conservation easement.

PRINTED ON 100% POST-CONSUMER RECYCLED PAPER

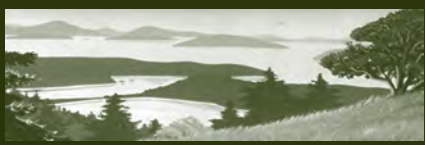

the SAN JUAN
PRESERVATION
TRUST

Land & Legacy

SUMMER 2008

WWW.SJPT.ORG

“This will likely be our only opportunity to conserve a mountaintop that provides so much joy to everyone who looks at it, walks up it and finds solitude on it. We hope that our children and grandchildren will be able to enjoy this special place the way we do. That’s why we are personally committed to making “The Mountain” accessible to the public, and ask you to join us in protecting this magnificent place.”

— Mark Linneman and Karen Everett,
Guemes Island residents and parents



JOHN SCURLOCK

A successful acquisition of “The Mountain” (foreground) will create a connected conservation area of more than 560 acres of wildlife habitat.

PUBLIC ACCESS IS KEY

The partnership believes that the community will be best served if the land is held by a public entity that can steward the property in a low impact and natural way while permitting public access. The property could also be owned by one of the land trusts, but no matter who owns “The Mountain” after it is protected, a land trust will hold a conservation easement on the property so that its natural character is forever protected.

CONSERVATION VISION FOR “THE MOUNTAIN” ON GUEMES

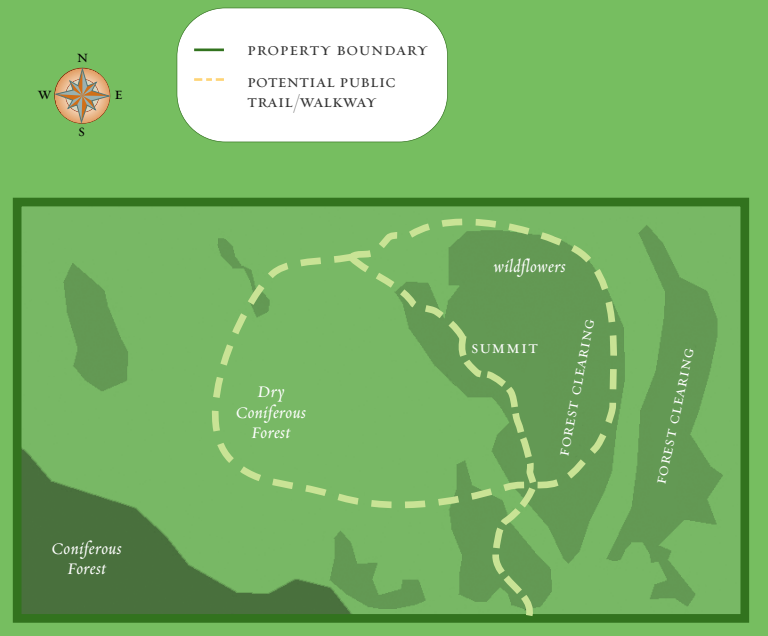

CAMPAIGN BUDGET PROJECT COSTS AT A GLANCE

Land purchase price:	\$ 2,590,000
Transaction costs:	\$ 210,000*
Total Project Goal	\$ 2,800,000
<hr/>	
Less Challenge Gift	\$ (1,000,000)
Less pledged donations as of August 20, 2008	\$ (230,000)
Funds Left to Raise	\$ 1, 570,000

* Transaction costs include legal fees, fundraising expenses, appraisals, environmental reviews and other costs.

THE CAMPAIGN TO SAVE THE MOUNTAIN ON GUEMES ISLAND FUNDRAISING FEASIBILITY PHASE (Deadline: November 1, 2008)

WITH ITS COMBINATION OF ECOLOGICAL AND CULTURAL VALUES, the Guemes Island community has long-recognized “The Mountain” as a critical part of its natural heritage. In fact, a recent community planning effort confirmed that the property is a top priority for conservation. Guemes Island community representatives approached Skagit Land Trust in 2006 to seek support for acquiring the property. The San Juan Preservation Trust, active for many years on Guemes Island, has joined the conservation effort.

As real estate values soar in the islands, and as countless signature properties are lost to development, “The Mountain” on Guemes has remained safe...UNTIL NOW!

Photos by: Ferdi Businger, Peter Dederich, Kathleen Foley, Sven Haarhoff, Susan Mazzarella

THE MOUNTAIN’S CONSERVATION VALUES

- 1. UNDEVELOPED RIDGELINE:** The summit will never be developed and will remain forever dark at night.
- 2. HABITAT RESTORATION:** Important wildflower, native plant and animal habitats will be restored and protected.
- 3. CONNECTIVITY:** The 70-acre property connects a number of adjacent private and public nature preserves, creating 560 acres of contiguous open space and wildlife habitat that extends to Square Harbor and surrounding shoreline protecting the heart of Guemes Island.
- 4. PUBLIC ACCESS:** Walking trails will provide visitors with access to spectacular vistas (some of the best views in northern Puget Sound) wildflower blooms, and other natural features.
- 5. WATER QUALITY:** A significant source of fresh water runoff, “The Mountain” serves water to important riparian and wetland habitats, underground aquifers and local agricultural uses before emptying into Puget Sound.

POTENTIAL BUILDOUT UNDER CURRENT ZONING

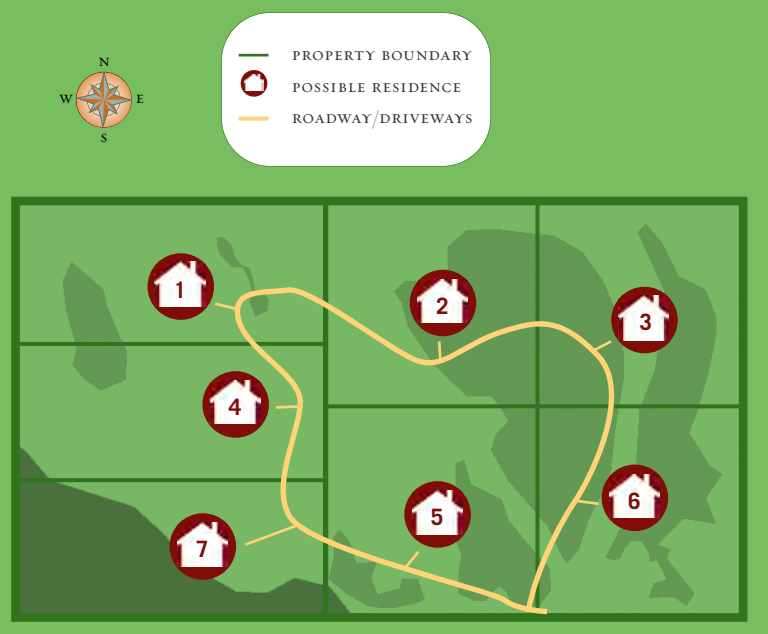

UNDER CURRENT ZONING seven houses and accompanying structures could be built.

DEDICATED ISLANDERS FORM STEERING COMMITTEE

The following people have a strong interest in protecting the rural character of Guemes and saving the “The Mountain” from development. They have voluntarily committed their time, energy, ideas and resources to this important conservation project. Many thanks to:

- | | |
|-------------------------------------|-----------------------|
| Paul Beudet and David Wertheimer | Mark Linneman |
| Chip Bogosian | Phil McCracken |
| Joost Businger and Marianne Kooiman | Mark Hitchcock |
| Carl and Ann Cady | Libby Mills |
| Karen Everett | and Rusty Kuntze |
| Janice Martin | Joe and Terri Gaffney |
| Charles Givens | Chris Gulick |
| Rick Machin | Stewart Landefeld |

THE TIME TO HELP IS NOW!

We will likely never again have the opportunity to protect this magnificent property from development and keep it open to the public for generations to come. We have only a few months – until November – to secure pledges for large donations. Please join us in saving “The Mountain” and making this dream a reality. To learn more about how you can support this effort, please contact us at 360.378.2461, or visit www.sjpt.org.

